



28th, 29th & 30th
MARCH 2019



SHOWING THE DOWNS SINCE 1860

HERITAGE BANK TOOWOOMBA ROYAL SHOW

The production of the very best in the region had been the aim of agriculturalists and horticulturalists on the Darling Downs since 1860, when the foundation bodies of the Darling Downs Agricultural Society and the Drayton and Toowoomba Agricultural and horticultural Society were formed.

Established to promote the improvement of stock and the develop the pastoral, agricultural and horticultural resources of the colony of Queensland, the Royal Agricultural Society continues to not only uphold this vision of agricultural excellence but to take a more proactive role in the education of young people within our communities.

The 155th Heritage Bank Toowoomba Royal Show will be held from the 28th -30th March 2019. It is expected in excess of 40000 patrons will attend over the three days.

Entertainment will again be a major driver in attendance and will be located strategically around the grounds. Specific timed events will not only improve traffic flow but will encourage patrons to plan and lengthen their time spent at the show.

Educating young people about the importance of agriculture is one of the charters of the society and we are again planning to increase our Edible Garden and Little Hands on the Farm programs.



In excess of 12 000 competitive entries were judged across 33 competition categories at the 2018 show. We would expect similar entries for the 2019 show.

Over 200 volunteers assist during the show. Without their dedication and effort the show could not function. Our theme for 2019 will be “enhancing community engagement” and again we plan to donate up to \$50 000 worth of complimentary passes and payments to community groups for services provided.



**FOUNDERS PAVILION SITE
LAYOUT FOR 2019 TOOWOOMBA
ROYAL SHOW**

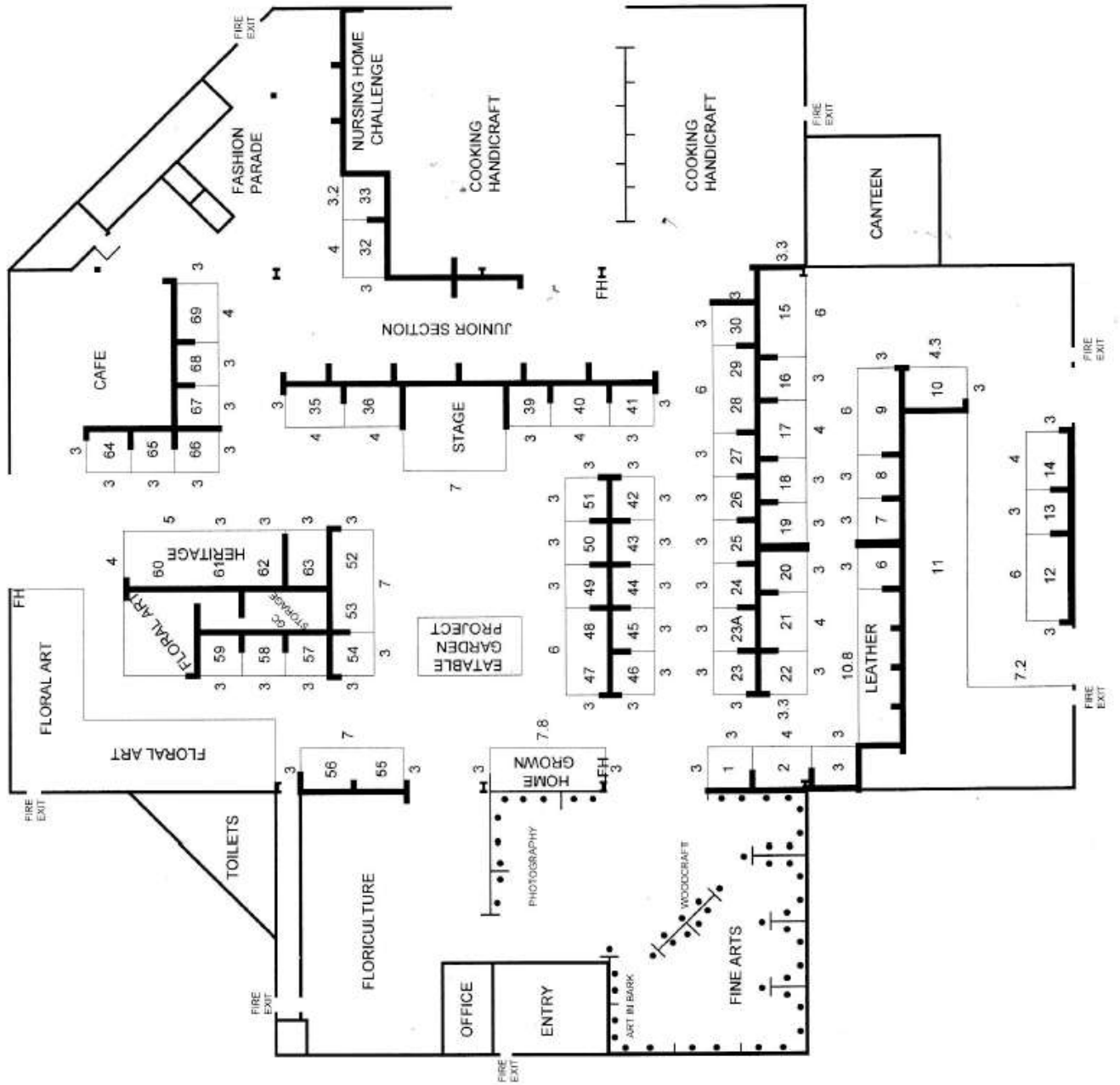

I would like to invite you to participate as an exhibitor at the 2019 Heritage Bank Toowoomba Royal Show.

- ✓ Flexible site sizes
- ✓ Cost effective site pricing
- ✓ Electricity connection at no additional cost
- ✓ Complimentary listing in show program
- ✓ Complimentary public address announcements
- ✓ Carpeted wall panels (inside sites only)



INDOOR SITES

- | | |
|-------------------|-----------------|
| ✚ 3mt x 3mt (min) | \$495 |
| ✚ Extra Frontage | \$165 per metre |

NB. Sites 35FP – 40FP & 47FP – 51FP will be restricted to Food/Beverage Exhibitors

NORTHERN PARK

- | | |
|------------------------|--------------------------|
| ✚ Commercial 3mt depth | \$135 per metre frontage |
|------------------------|--------------------------|

NORTHERN PARK

- | | |
|----------------------|--------------------------|
| ✚ Catering 3mt depth | \$200 per metre frontage |
|----------------------|--------------------------|

CENTRAL PARK

- | | |
|------------------------|--------------------------|
| ✚ Commercial 3mt depth | \$115 per metre frontage |
|------------------------|--------------------------|

CENTRAL PARK FOOD & ENTERTAINMENT PRECINCT

- | | |
|----------------------|--------------------------|
| ✚ Catering 3mt depth | \$150 per metre frontage |
|----------------------|--------------------------|

VILLAGE GREEN

- | | |
|--------------------------------------|--------------------------|
| ✚ Commercial & Catering
3mt depth | \$115 per metre frontage |
|--------------------------------------|--------------------------|

Sites in the Village Green & Central Park requiring more than 3 metres depth will be charged by the square metre starting at:

- | | |
|--------------|-----------------------|
| ✚ Commercial | \$35 per square metre |
| ✚ Catering | \$50 per square metre |

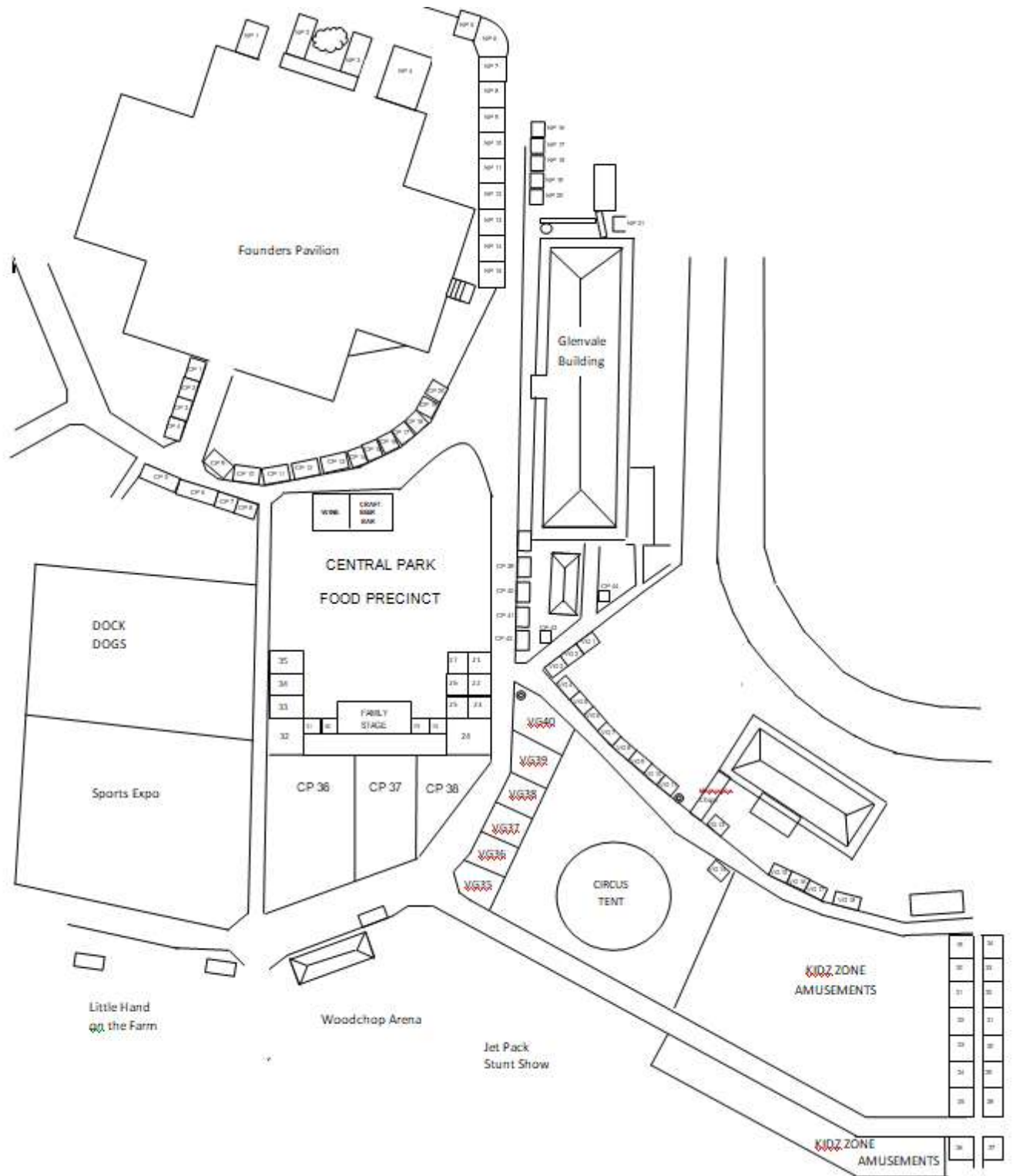

2019 SITE CONTRACT

28th, 29th & 30th March



EXHIBITOR DETAILS

Exhibitor name:		
Contact person:		
Email:		
Postal address:		
Town / City:	State:	Postcode:
Phone:	Mobile:	

INSURANCE

Yes, I agree to hold public liability insurance (please attach copy)

Insurance company name:	
Policy number:	\$ Cover:

SITE BOOKING DETAILS

Site Number:	Site size:
--------------	------------

Do you require water? Yes No

Do you require electricity? Yes No

Type of connection required: Single phase 240 volt 3 phase 415 volt

Office use only

Site number:

Frontage:

Depth:

Total metres:

Extra Exhibitor pass:

Camping:

Total cost:

SITE LOCATION

EXTERNAL SITE

Central Park Village Green

Northern Park Southern Park

FOUNDERS PAVILION

Section One – 7pm Close Section Two – 9pm Close

All exhibitors receive 3 x 3 day complimentary passes. Additional passes are available for purchase at the discounted rate of \$10 per day. Limits apply. Extra tickets must be purchased prior the start of show.

How many extra tickets do you require? 3 Day Passes 1 Day Passes

PRODUCT DESCRIPTION

Please indicate the products you will have on display: _____

CAMPING (\$25 pre night. Tick days required.)

Wednesday Thursday Friday Saturday

CATERING SITE

ENVIRONMENTAL HEALTH & SAFETY

Yes, I agree to hold a environmental Health & Safety Accreditations & Licences (please attach copy) Either with Toowoomba Regional Council or with relevant council permitting to trade outside that council area.

Name on Licence:

Van Health Certification No:

Certified by:

Food Accreditation Licence No:

BOOKING DEPOSIT: \$100

The \$100 Booking Deposit must be paid with your Site Agreement to guarantee a site allocation. The Site Deposit will be deducted from the final balance of site payment.

FINAL PAYMENT IS DUE BY THE 22nd March 2019.

PAYMENT DETAILS

Cheque: made payable to RASQ EFT: Rabobank BSB: 142001 A/C: 133296800

Visa Mastercard

Cardholder name:

Card number:

Expiry date:

 /

Amount to deduct:

\$

DECLARATION

I hereby acknowledge having read the terms and conditions of the application agreement in this prospectus and agree to be bound by those terms and conditions. I agree to provide Public and Product Risk Insurance Certificate of Currency. If I sign this application as an employee, servant or agent of the participant, I warrant that I have the authority to enter into this agreement on behalf of the participant and agree to be personally bound by the terms and conditions of the agreement.

Company Name:

Authorised by (print):

Signature:

**This form is also available at
www.rasq.com.au**

Please complete and return to:
Fax: 07 4633 2495 or

Post: PO Box 18099, Clifford Gardens,
Toowoomba Q 4350

Email: rasq-ceo@rasq.com.au